

CR1/3N Brief Datasheet

Lithium Manganese Dioxide Battery

1 BASIC SPECIFICATION

(Typical values relative to cells stored for one year or less at + 30 °C max.)

Nominal capacity (at 1mA, +23 °C) * ¹	160mAh
Nominal voltage	3.0V
Standard discharge current	1mA
Maximum continuous current	5mA
Maximum pulse current * ²	80mA
Operating temperature range * ³	-30 °C- +60 °C
Storage temperature (recommended)	+30 °C Max
Weight	3.3g

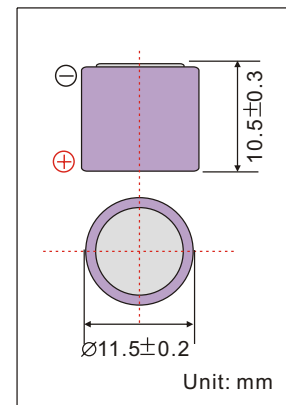

Note:

- *1 At 1mA discharge current to 2.0V cut-off, +23 °C. The capacity stored by the cell varies according to current drain, temperature and cut-off.
- *2 The readings may vary according to the pulse characteristics, the temperature, and the cell's previous history.
- *3 Operation above ambient temperature range may lead to reduced capacity and lower voltage readings at the beginning of pulses. Consult Autec Battery.

2 MAIN FEATURES

- Best suited for high current discharge for both continuous and pulse current.
- Light Weight, High Voltage and High Energy Density.
- Excellent Stable Discharge Characteristics and Outstanding Temperature Characteristics.
- Excellent Leakage Resistance and Excellent Long-term Reliability.

3 ELECTRICAL CHARACTERISTICS

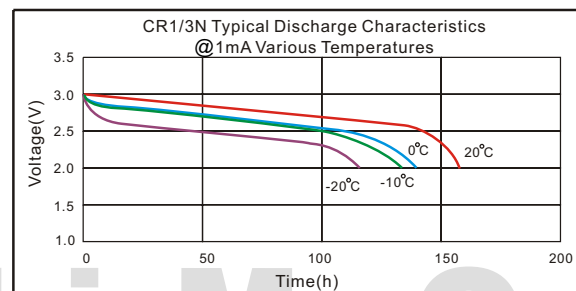
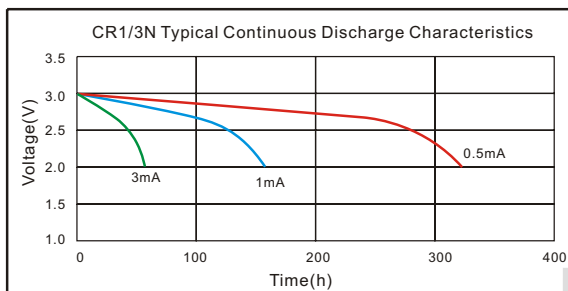

Note: Any representations in this brochure concerning performance, are for informational purposes only and are not construed as warranties either expressed or implied, of future performance.